

ASSEMBLY & INSTALLATION

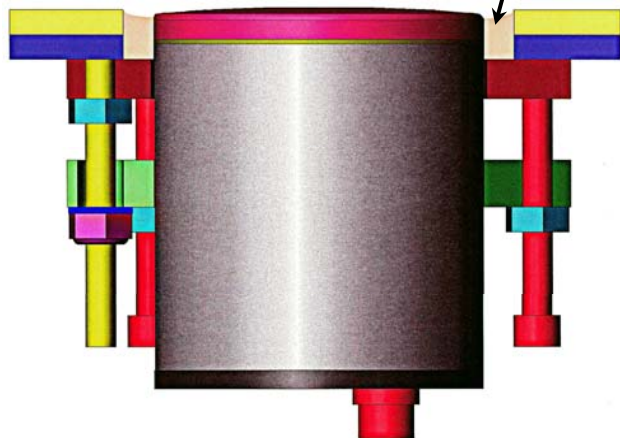

Hydro-Mix Fixing Clamp

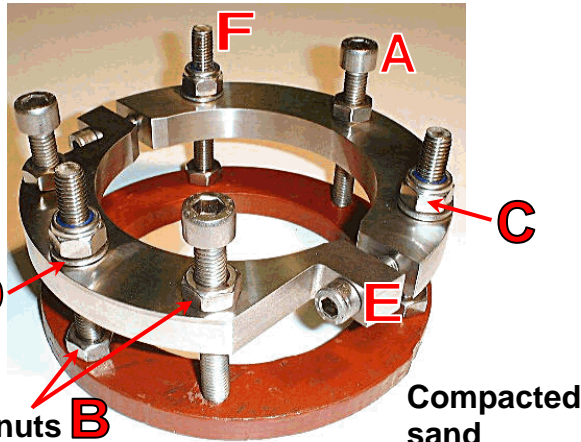
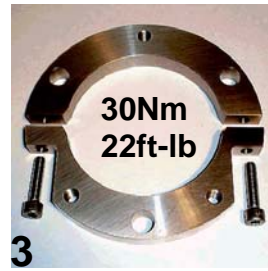
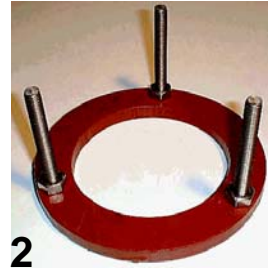
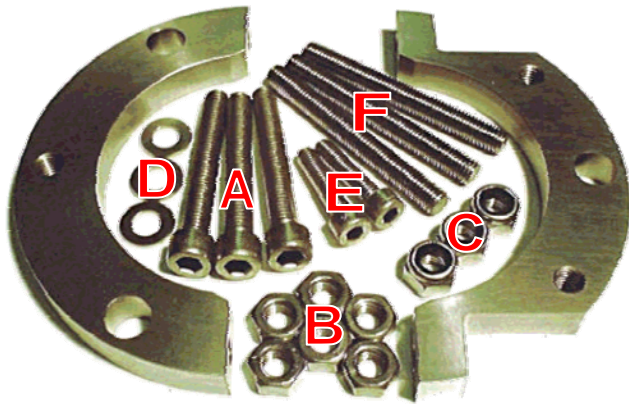
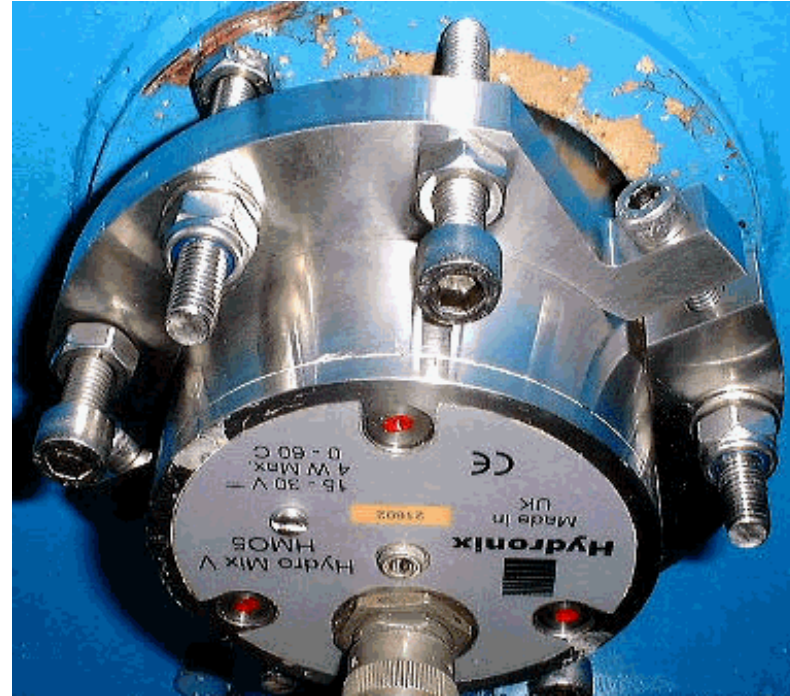

Hydronix
www.hydronix.com

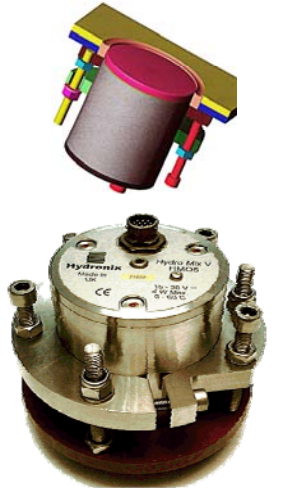

HD0226.1.1.0

ADJUSTMENT

To move sensor IN to mixer:

1. Clean out compacted sand
2. Loosen locknuts B
3. Loosen screws A
4. Tighten nuts C evenly (max.50Nm/37ft-lb) until sensor in desired position
5. Tighten screws A (20Nm/15ft-lb)
6. Tighten locknuts B (40Nm/30ft-lb)
7. Compact sand into gap

To move sensor OUT of mixer:

1. Clean out compacted sand
2. Loosen locknuts B
3. Loosen nuts C
4. Tighten screws A evenly (max. 60Nm/45ft-lb) until sensor in desired position
5. Tighten nuts C (20Nm/15ft-lb)
6. Tighten locknuts B (40Nm/30ft-lb)
7. Compact sand into gap

8. READ THE USER GUIDE FOR MORE INFORMATION

REMOVAL

1. Clean out compacted sand
2. Loosen locknuts B
3. Remove nuts C
4. Tighten screws A evenly (max. 60Nm/45ft-lb)

